



OPTIONS

Construction:

- carbon steel (s235Jr)
- stainless steel (Aisi 304)
- corten steel

Mounting method:

- free-standing
- to screw

DESCRIPTION

The Stilo 06.148.L.1 model is an elevated version of the [Stilo 06.048.L.1](#) planter.

This planter is crafted entirely from riveted, bent steel sheets with a thickness of 2 mm.

Available steel options include:- stainless steel 1.4301 (AISI 304SS), polished- carbon steel (S235JR, DC01), galvanized and powder-coated in a [RAL](#) color chosen by the customer- corten steel

The planter features a drainage hole to allow water to exit. It is advised to use a liner inside the planter and, for outdoor applications, to insulate it with styrofoam.



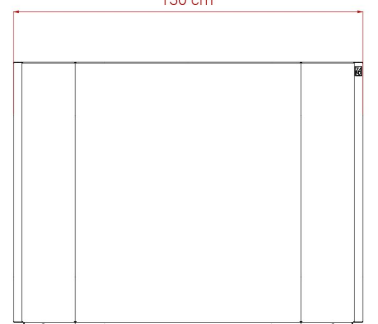
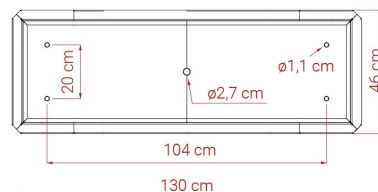
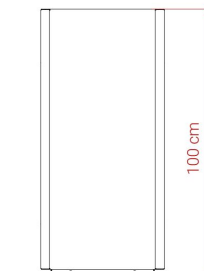
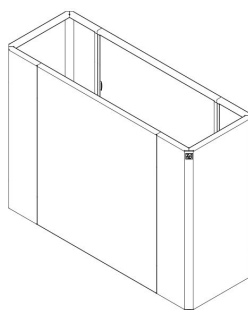

GENERAL TECHNICAL DATA

Dimensions:

- width: 51 1/4 in
- height: 100 mm
- depth: 46 mm

Weight:

- 187 lb

Materials:

- carbon steel, stainless steel, or corten

ZANO

Iwona Żaczek

Product: Stilo flower pot

Catalog number:

06.148.L.1

Designer: Iwona Żaczek

In accordance with the Polish Law on Copyright and Related Rights of 04.02.1994 (Official Journal of Laws No. 24, item 83, corrected: Journal of Laws No. 43, item 170) and in accordance with the EU copyright legislation including all EU directives and regulations on copyright, Zano Mirosław Zarotynski Company, reserves the copyright of drawings, descriptions, 3D models, renderings, graphics, content contained in offers, attachments to offers and all other documents. Its content is the intellectual property of ZANO Mirosław Zarotynski company. The use of author's ideas, solutions, copying, distribution of photos, graphics or fragments of graphics, descriptive texts, for profit, without the permission of the author - ZANO Mirosław Zarotynski company - is prohibited and constitutes a copyright infringement and is punishable.

NOTE: The drawings do not reflect the actual dimensions of the foundation. These are only sample installation diagrams taking into account the type of anchoring and the material of the substrate to which to attach the furniture.

The size of the foundation depends on local foundation conditions.



INSTALLATION TO PAVING WITH FOUNDATION

Installation description

1. ZANO product
2. Quick-attachment / quick-attachment or chemical anchor
3. Stone paving / concrete paving / stone slabs / concrete slabs
4. Sand ballast (approximately 2 - 4 cm)
5. Stone aggregate substructure
6. Concrete foundation of C16/20 class (top surface of concrete 10 cm below paving surface)
7. Local land



MOUNTING TO PAVING

Installation description

1. ZANO product
2. Quick-attachment / quick-attachment or chemical anchor
3. Stone paving / concrete paving / stone slabs / concrete slabs
4. Sand ballast (approximately 2 - 4 cm)
5. Stone aggregate substructure
6. Local land

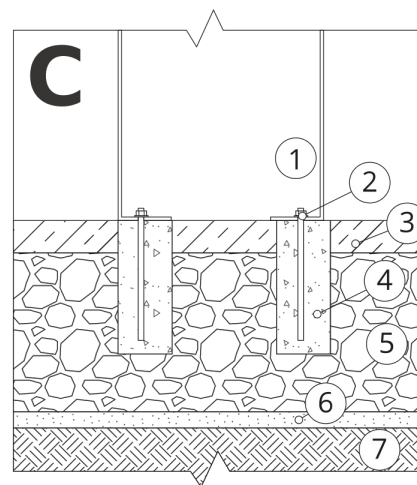

MOUNTING TO CONCRETE / ASPHALT

Installation description

1. ZANO product
2. Quick-attachment / quick-attachment or chemical anchor
3. Fixed restrained surface, such as concrete or asphalt
4. Concrete foundation of C16/20 class (top surface of concrete 10 cm below paving surface)
5. Stone aggregate substructure
6. Sand ballast (approximately 2 - 4 cm)
7. Local land



MOUNTING TO CONCRETE FOUNDATION

Installation description

1. ZANO product
2. Quick-attachment / quick-attachment or chemical anchor
3. Concrete foundation of C16/20 class (top surface of concrete 10 cm below paving surface)
4. Local land