



OPTIONS

Construction:

- carbon steel (s235Jr)
- stainless steel (Aisi 304)
- stainless steel (Aisi 316) - 1.4401 (X5CrNiMo17-12-2)

Mounting method:

- to screw

Contribution:

- galvanized sheet insert
- insert from galvanized sheet painted

DESCRIPTION

Tubus is a versatile trash can designed for both outdoor and indoor environments. Its unique design blends seamlessly with the aesthetics of contemporary urban settings. Featuring sleek decorative steel bars and satin-finish steel, it presents a stylish and sophisticated look. The bin is available in either black steel or stainless steel. Choosing stainless steel is particularly advised for outdoor settings due to its durability against mechanical wear and corrosion, eliminating the need for extra upkeep. Trash is removed from the Tubus can by unlocking and lifting the top lid. Optionally, an ashtray can be attached upon request. The Tubus model highlights the modernity and functionality of urban street furniture.



GENERAL TECHNICAL DATA

Dimensions:

- width: 17 in
- height: 31 1/2 in
- depth: 17 in

Weight:

- 123 lb

Capacity:

- capacity: 17 1/4 gal

Materials:

- stainless steel or carbon steel
- galvanized sheet insert

ZANO

M. Welmiński

Product: Tubus basket
 Catalog number: **03.053**
 Designer:
 Mateusz Welmiński

In accordance with the Polish Law on Copyright and Related Rights of 04.02.1994 (Official Journal of Laws No. 24, item 83, corrected: Journal of Laws No. 43, item 170) and in accordance with the EU copyright legislation including all EU directives and regulations on copyright, Zano Mirosław Zarotynski Company, reserves the copyright of drawings, descriptions, 3D models, renderings, graphics, content contained in offers, attachments to offers and all other documents. Its content is the intellectual property of ZANO Mirosław Zarotynski company. The use of author's ideas, solutions, copying, distribution of photos, graphics or fragments of graphics, descriptive texts, for profit, without the permission of the author - ZANO Mirosław Zarotynski company - is prohibited and constitutes a copyright infringement and is punishable.

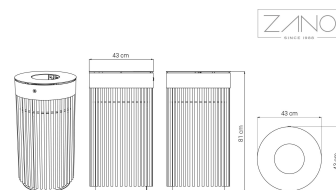

NOTE: The drawings do not reflect the actual dimensions of the foundation. These are only sample installation diagrams taking into account the type of anchoring and the material of the substrate to which to attach the furniture.

The size of the foundation depends on local foundation conditions.



INSTALLATION TO PAVING WITH FOUNDATION

Installation description

1. ZANO product
2. Quick-attachment / quick-attachment or chemical anchor
3. Stone paving / concrete paving / stone slabs / concrete slabs
4. Sand ballast (approximately 2 - 4 cm)
5. Stone aggregate substructure
6. Concrete foundation of C16/20 class (top surface of concrete 10 cm below paving surface)
7. Local land



MOUNTING TO PAVING

Installation description

1. ZANO product
2. Quick-attachment / quick-attachment or chemical anchor
3. Stone paving / concrete paving / stone slabs / concrete slabs
4. Sand ballast (approximately 2 - 4 cm)
5. Stone aggregate substructure
6. Local land

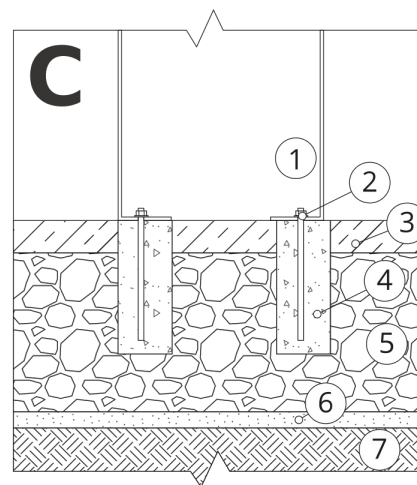

MOUNTING TO CONCRETE / ASPHALT

Installation description

1. ZANO product
2. Quick-attachment / quick-attachment or chemical anchor
3. Fixed restrained surface, such as concrete or asphalt
4. Concrete foundation of C16/20 class (top surface of concrete 10 cm below paving surface)
5. Stone aggregate substructure
6. Sand ballast (approximately 2 - 4 cm)
7. Local land



MOUNTING TO CONCRETE FOUNDATION

Installation description

1. ZANO product
2. Quick-attachment / quick-attachment or chemical anchor
3. Concrete foundation of C16/20 class (top surface of concrete 10 cm below paving surface)
4. Local land