

## OPTIONS

---

### Construction:

- carbon steel (s235Jr)
- stainless steel (Aisi 304)

### Housing:

- European coniferous wood
- hardwood of European origin
- oiled exotic wood
- premium exotic wood
- HPL board

### Mounting method:

- to screw

### Contribution:

- galvanized sheet insert

## DESCRIPTION

---

**Flash Five-Chamber Recycling Trash Bin.** This is part of [the Flash furniture series](#) and features a 195 cm long recycling trash bin. It boasts a unique, contemporary appearance with horizontally placed slats. Furthermore, customization options are available so that the slats can display specific information regarding the type of waste each bin is designed for.

Each compartment contains a galvanized sheet metal liner. The standard wood options include spruce, pine, or exotic types such as iroko, sapeli, or meranti. Upon request, any wood type can be used for the construction. The wood is finished with either varnish or oil (for exotic woods). A selection of **varnish and oil colors** is available. The bin's structure is made of stainless steel, or alternatively, carbon steel that's galvanized and powder-coated in any **RAL color**.

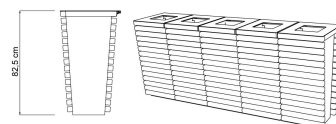
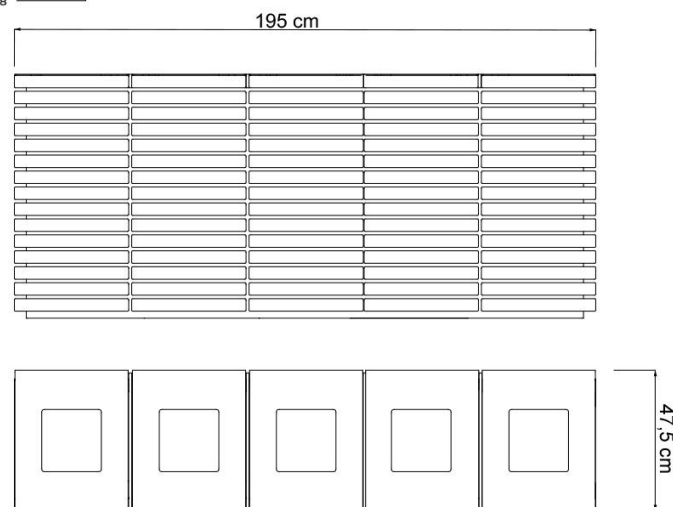

## GENERAL TECHNICAL DATA

### Dimensions:

- width: 76  $\frac{3}{4}$  in
- height: 32  $\frac{1}{4}$  in
- depth: 18  $\frac{3}{4}$  in

### Capacity:

- number of containers: 5 szt.
- capacity of one container: 19  $\frac{3}{4}$  gal

### Materials:

- construction - steel, wood
- container - galvanized steel

ZANO

In accordance with the Polish Law on Copyright and Related Rights of 04.02.1994 (Official Journal of Laws No. 24, item 83, corrected: Journal of Laws No. 43, item 170) and in accordance with the EU copyright legislation including all EU directives and regulations on copyright, Zano Mirosław Zarotynski Company, reserves the copyright of drawings, descriptions, 3D models, renderings, graphics, content contained in offers, attachments to offers and all other documents. Its content is the intellectual property of ZANO Mirosław Zarotynski company. The use of author's ideas, solutions, copying, distribution of photos, graphics or fragments of graphics, descriptive texts, for profit, without the permission of the author - ZANO Mirosław Zarotynski company - is prohibited and constitutes a copyright infringement and is punishable.

**NOTE:** The drawings do not reflect the actual dimensions of the foundation. These are only sample installation diagrams taking into account the type of anchoring and the material of the substrate to which to attach the furniture.

The size of the foundation depends on local foundation conditions.



### INSTALLATION TO PAVING WITH FOUNDATION

#### Installation description

1. ZANO product
2. Quick-attachment / quick-attachment or chemical anchor
3. Stone paving / concrete paving / stone slabs / concrete slabs
4. Sand ballast (approximately 2 - 4 cm)
5. Stone aggregate substructure
6. Concrete foundation of C16/20 class (top surface of concrete 10 cm below paving surface)
7. Local land

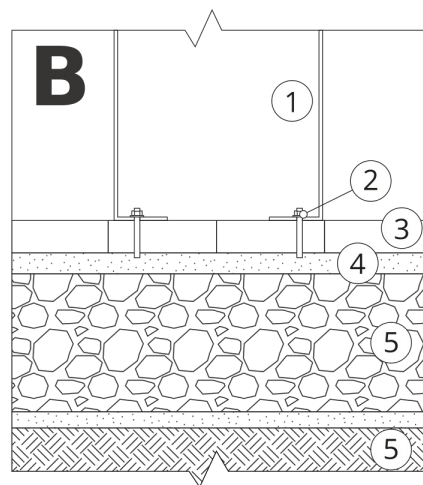

### MOUNTING TO PAVING

#### Installation description

1. ZANO product
2. Quick-attachment / quick-attachment or chemical anchor
3. Stone paving / concrete paving / stone slabs / concrete slabs
4. Sand ballast (approximately 2 - 4 cm)
5. Stone aggregate substructure
6. Local land

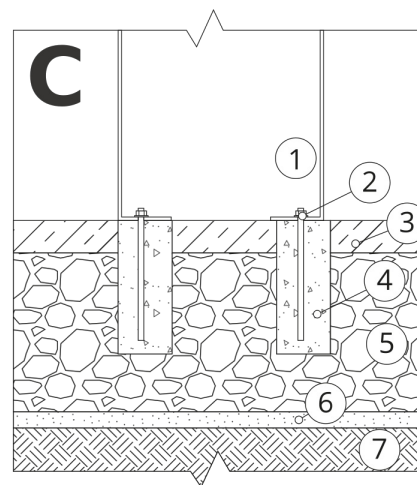

### MOUNTING TO CONCRETE / ASPHALT

#### Installation description

1. ZANO product
2. Quick-attachment / quick-attachment or chemical anchor
3. Fixed restrained surface, such as concrete or asphalt
4. Concrete foundation of C16/20 class (top surface of concrete 10 cm below paving surface)
5. Stone aggregate substructure
6. Sand ballast (approximately 2 - 4 cm)
7. Local land

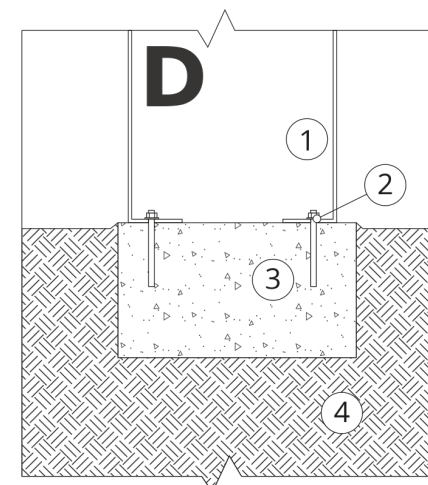

### MOUNTING TO CONCRETE FOUNDATION

#### Installation description

1. ZANO product
2. Quick-attachment / quick-attachment or chemical anchor
3. Concrete foundation of C16/20 class (top surface of concrete 10 cm below paving surface)
4. Local land