

OPTIONS

Construction:

- carbon steel (s235Jr)
- stainless steel (Aisi 304)

Seat:

- European coniferous wood
- hardwood of European origin
- oiled exotic wood
- premium exotic wood
- carbon steel (s235Jr)
- stainless steel (Aisi 304)
- HPL board

Mounting method:

- to screw

DESCRIPTION

The IVO bench model 02.445.2 stretches to a length of 195 cm, making it an expanded version of our standard bench that comes without a backrest or armrests. Its increased length provides the flexibility to arrange three or more benches around a central object like a tree or table. This bench is crafted from powder-coated carbon steel available in any RAL paint color, while the seating surface is constructed from either spruce or pine wood, also finished with paint. IVO benches are available in two lengths, 165 and 195 cm, and are offered in three different styles: the basic model which lacks both a backrest and armrests, a version with a backrest, and another with both backrest and armrests. The design of these benches allows for versatile configurations, whether aligned in a row or shaped into enclosed forms. For example, the longer benches can be organized into a triangular shape encircling a tree, and a flowerpot can...



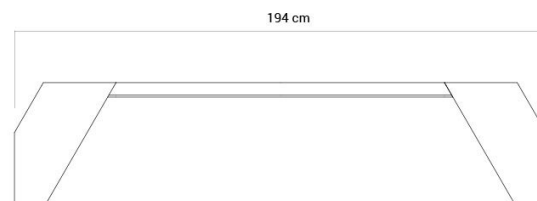
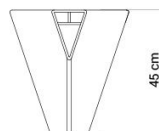

GENERAL TECHNICAL DATA

Dimensions:

- width: 17 1/4 in
- length: 76 3/4 in
- height: 17 3/4 in

Weight:

- 132 lb

Materials:

- stainless steel or carbon steel
- spruce or pine wood

ZANO



Iwona Żaczek

Product: IVO bench
Catalog number: **02.445.2**
Designer: Iwona Żaczek

In accordance with the Polish Law on Copyright and Related Rights of 04.02.1994 (Official Journal of Laws No. 24, item 83, corrected: Journal of Laws No. 43, item 170) and in accordance with the EU copyright legislation including all EU directives and regulations on copyright, Zano Mirosław Zarotynski Company, reserves the copyright of drawings, descriptions, 3D models, renderings, graphics, content contained in offers, attachments to offers and all other documents. Its content is the intellectual property of ZANO Mirosław Zarotynski company. The use of author's ideas, solutions, copying, distribution of photos, graphics or fragments of graphics, descriptive texts, for profit, without the permission of the author - ZANO Mirosław Zarotynski company - is prohibited and constitutes a copyright infringement and is punishable.

NOTE: The drawings do not reflect the actual dimensions of the foundation. These are only sample installation diagrams taking into account the type of anchoring and the material of the substrate to which to attach the furniture.

The size of the foundation depends on local foundation conditions.



INSTALLATION TO PAVING WITH FOUNDATION

Installation description

1. ZANO product
2. Quick-attachment / quick-attachment or chemical anchor
3. Stone paving / concrete paving / stone slabs / concrete slabs
4. Sand ballast (approximately 2 - 4 cm)
5. Stone aggregate substructure
6. Concrete foundation of C16/20 class (top surface of concrete 10 cm below paving surface)
7. Local land



MOUNTING TO PAVING

Installation description

1. ZANO product
2. Quick-attachment / quick-attachment or chemical anchor
3. Stone paving / concrete paving / stone slabs / concrete slabs
4. Sand ballast (approximately 2 - 4 cm)
5. Stone aggregate substructure
6. Local land

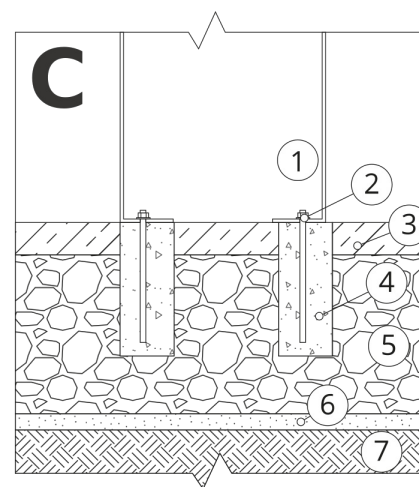

MOUNTING TO CONCRETE / ASPHALT

Installation description

1. ZANO product
2. Quick-attachment / quick-attachment or chemical anchor
3. Fixed restrained surface, such as concrete or asphalt
4. Concrete foundation of C16/20 class (top surface of concrete 10 cm below paving surface)
5. Stone aggregate substructure
6. Sand ballast (approximately 2 - 4 cm)
7. Local land



MOUNTING TO CONCRETE FOUNDATION

Installation description

1. ZANO product
2. Quick-attachment / quick-attachment or chemical anchor
3. Concrete foundation of C16/20 class (top surface of concrete 10 cm below paving surface)
4. Local land