



OPTIONS

Construction:

- carbon steel (s235Jr)

Mounting method:

- to screw

Pergola roof:

- European coniferous wood
- hardwood of European origin
- oiled exotic wood
- premium exotic wood

DESCRIPTION

The pergola is a charming garden feature made from a robust steel frame and horizontal beams, with the option to add walls with steel cables for climbing plants. It's perfect for setting up a shaded spot outdoors, enhancing the visual charm of a garden, park, or patio. Our Pergola provides sun protection, amplifying the usability of your outdoor area whether it's at home, your workplace, or a public garden or park space.

The structure of the pergola is crafted by bending, welding, and bolting together 120 x 114 mm I-beams and 120 x 80 mm rectangular segments made of carbon steel S235Jr, which is galvanized and powder-coated based on the RAL color chart. The pergola's roof uses 17 planks measuring 45 x 70 x 2740 mm, made from European coniferous wood that's been impregnated and varnished twice or exotic wood that's been impregnated and oiled twice. There's also the option to finish the side walls of the pergola with either boards or steel cables.

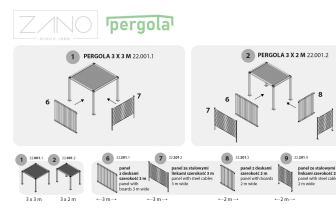
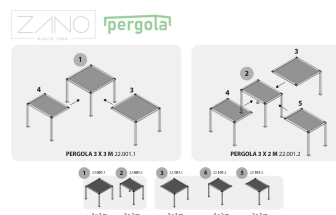

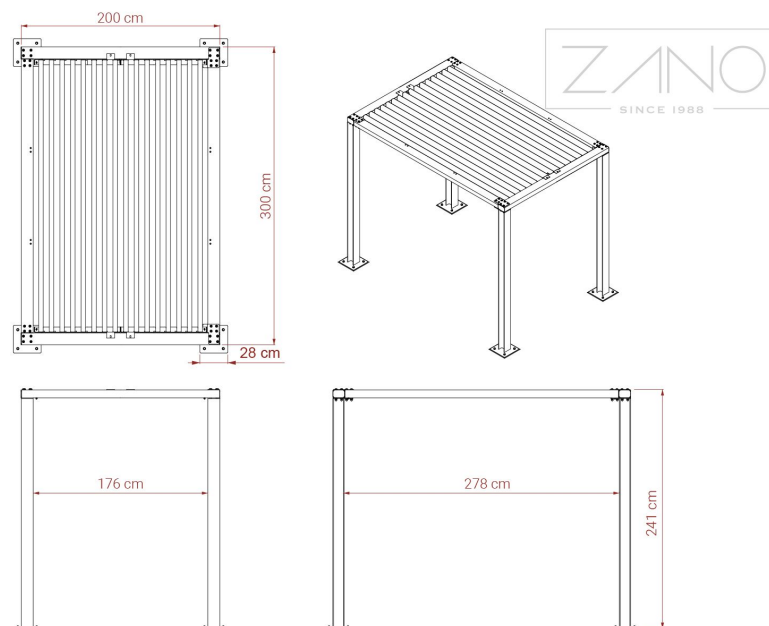

GENERAL TECHNICAL DATA

Dimensions:

- width: 118 in
- height: 95 in
- depth: 78 ³/₄ in

Materials:

- wood: European coniferous or exotic wood
- Carbon steel, galvanized, painted in RAL color

ZANO



Iwona Żaczek

Product: Pergola 3 x 2 m
Catalog number: **22.001.2**
Designer: Iwona Żaczek

In accordance with the Polish Law on Copyright and Related Rights of 04.02.1994 (Official Journal of Laws No. 24, item 83, corrected: Journal of Laws No. 43, item 170) and in accordance with the EU copyright legislation including all EU directives and regulations on copyright, Zano Mirosław Zarotynski Company, reserves the copyright of drawings, descriptions, 3D models, renderings, graphics, content contained in offers, attachments to offers and all other documents. Its content is the intellectual property of ZANO Mirosław Zarotynski company. The use of author's ideas, solutions, copying, distribution of photos, graphics or fragments of graphics, descriptive texts, for profit, without the permission of the author - ZANO Mirosław Zarotynski company - is prohibited and constitutes a copyright infringement and is punishable.

NOTE: The drawings do not reflect the actual dimensions of the foundation. These are only sample installation diagrams taking into account the type of anchoring and the material of the substrate to which to attach the furniture.

The size of the foundation depends on local foundation conditions.



INSTALLATION TO PAVING WITH FOUNDATION

Installation description

1. ZANO product
2. Quick-attachment / quick-attachment or chemical anchor
3. Stone paving / concrete paving / stone slabs / concrete slabs
4. Sand ballast (approximately 2 - 4 cm)
5. Stone aggregate substructure
6. Concrete foundation of C16/20 class (top surface of concrete 10 cm below paving surface)
7. Local land

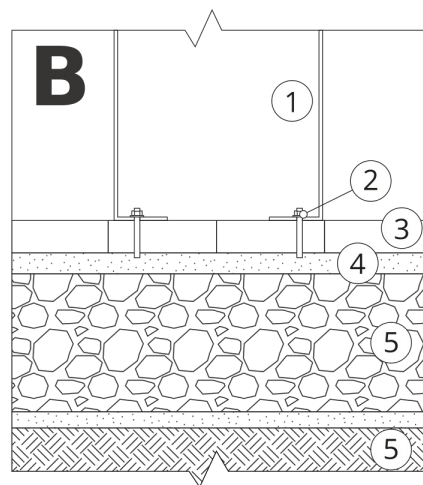

MOUNTING TO PAVING

Installation description

1. ZANO product
2. Quick-attachment / quick-attachment or chemical anchor
3. Stone paving / concrete paving / stone slabs / concrete slabs
4. Sand ballast (approximately 2 - 4 cm)
5. Stone aggregate substructure
6. Local land

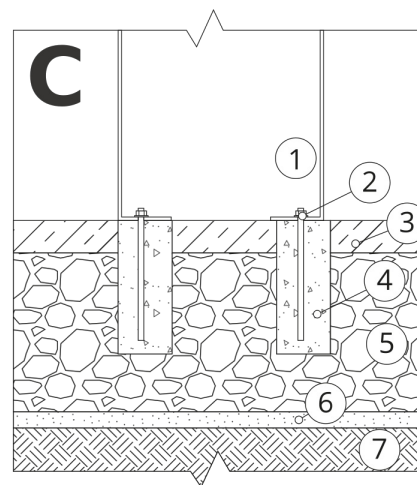

MOUNTING TO CONCRETE / ASPHALT

Installation description

1. ZANO product
2. Quick-attachment / quick-attachment or chemical anchor
3. Fixed restrained surface, such as concrete or asphalt
4. Concrete foundation of C16/20 class (top surface of concrete 10 cm below paving surface)
5. Stone aggregate substructure
6. Sand ballast (approximately 2 - 4 cm)
7. Local land

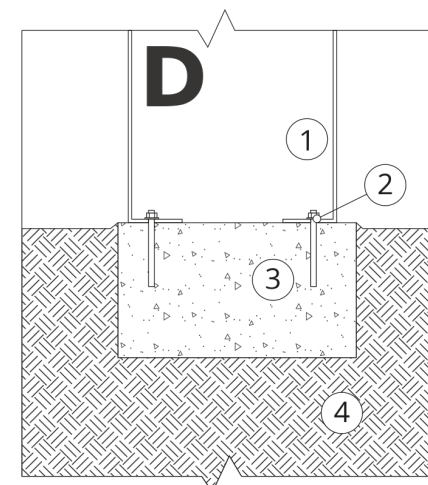

MOUNTING TO CONCRETE FOUNDATION

Installation description

1. ZANO product
2. Quick-attachment / quick-attachment or chemical anchor
3. Concrete foundation of C16/20 class (top surface of concrete 10 cm below paving surface)
4. Local land