



OPTIONS

Construction:

- carbon steel (s235Jr)
- stainless steel (Aisi 304)

Seat and backrest:

- European coniferous wood
- hardwood of European origin
- oiled exotic wood
- premium exotic wood

Mounting method:

- to screw

DESCRIPTION

The Travetto bench is an elegant addition with classic design elements that will elevate any area within modern urban settings.

Travetto features a combination of wood and steel in its construction. Options include either black or stainless steel. While benches typically run 2 meters in length, the Travetto extends to **3 meters**, distinguishing it from comparable offerings.

The seat's wooden slats are vertically aligned, enhancing their **resistance to warping**. These slats are linked together by a stainless steel rod that ensures consistent spacing between them and **adds robustness to the structure**. Three shorter planks under the seat offer ergonomic support for the back, making the sizable bench look deceptively light.

A notable aspect of **this** bench is its **modular design**, allowing for the coupling of multiple units to form, say, a **single 15-meter bench**. The wood receives a special finish for weather resistance, similar to the steel, which benefits from strong galvanization and can be powder coated in any hue from the Ral color chart. Furthermore, the bench can be securely mounted to...

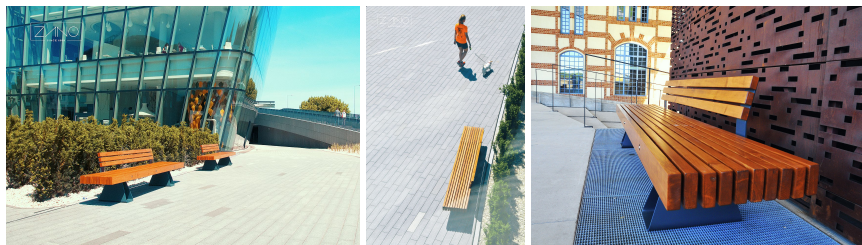



GENERAL TECHNICAL DATA

Dimensions:

- width: 19 1/4 in
- length: 117 3/4 in
- height: 28 1/4 in

Weight:

- 265 lb

Materials:

- wood: European coniferous or exotic
- carbon steel (s235jr) - carbon steel ASTM A36
- stainless steel (1.4301) - stainless steel AISI 304SS

ZANO



Product: Travetto bench
Catalog number: **02.007**
Designer: Filip Babiarz

In accordance with the Polish Law on Copyright and Related Rights of 04.02.1994 (Official Journal of Laws No. 24, item 83, corrected: Journal of Laws No. 43, item 170) and in accordance with the EU copyright legislation including all EU directives and regulations on copyright, Zano Mirosław Zarotynski Company, reserves the copyright of drawings, descriptions, 3D models, renderings, graphics, content contained in offers, attachments to offers and all other documents. Its content is the intellectual property of ZANO Mirosław Zarotynski company. The use of author's ideas, solutions, copying, distribution of photos, graphics or fragments of graphics, descriptive texts, for profit, without the permission of the author - ZANO Mirosław Zarotynski company - is prohibited and constitutes a copyright infringement and is punishable.

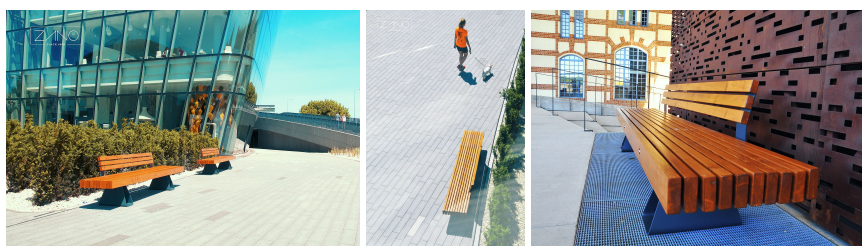

NOTE: The drawings do not reflect the actual dimensions of the foundation. These are only sample installation diagrams taking into account the type of anchoring and the material of the substrate to which to attach the furniture.

The size of the foundation depends on local foundation conditions.

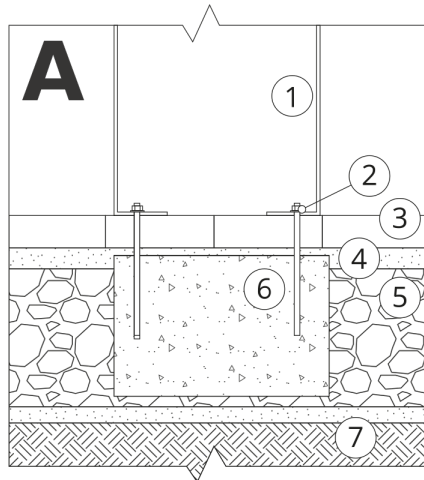

INSTALLATION TO PAVING WITH FOUNDATION

Installation description

1. ZANO product
2. Quick-attachment / quick-attachment or chemical anchor
3. Stone paving / concrete paving / stone slabs / concrete slabs
4. Sand ballast (approximately 2 - 4 cm)
5. Stone aggregate substructure
6. Concrete foundation of C16/20 class (top surface of concrete 10 cm below paving surface)
7. Local land

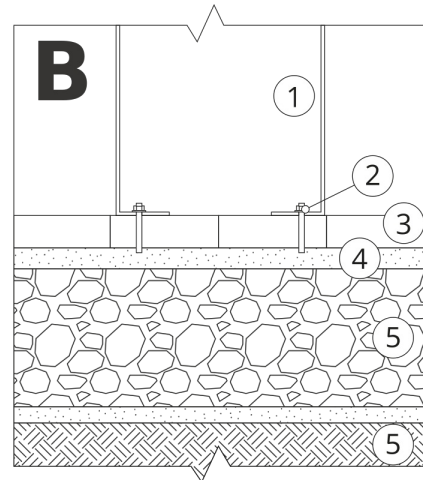

MOUNTING TO PAVING

Installation description

1. ZANO product
2. Quick-attachment / quick-attachment or chemical anchor
3. Stone paving / concrete paving / stone slabs / concrete slabs
4. Sand ballast (approximately 2 - 4 cm)
5. Stone aggregate substructure
6. Local land

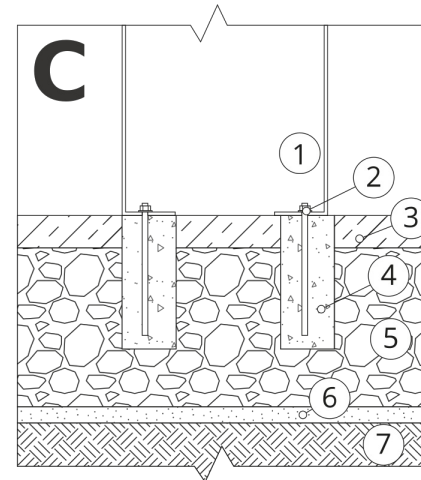

MOUNTING TO CONCRETE / ASPHALT

Installation description

1. ZANO product
2. Quick-attachment / quick-attachment or chemical anchor
3. Fixed restrained surface, such as concrete or asphalt
4. Concrete foundation of C16/20 class (top surface of concrete 10 cm below paving surface)
5. Stone aggregate substructure
6. Sand ballast (approximately 2 - 4 cm)
7. Local land

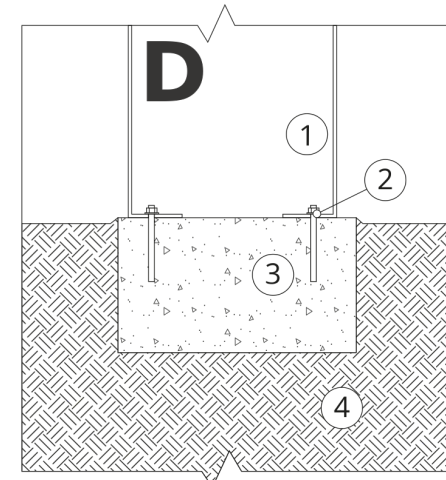

MOUNTING TO CONCRETE FOUNDATION

Installation description

1. ZANO product
2. Quick-attachment / quick-attachment or chemical anchor
3. Concrete foundation of C16/20 class (top surface of concrete 10 cm below paving surface)
4. Local land