

## OPTIONS

### Construction:

- carbon steel (s235Jr)
- stainless steel (Aisi 304)

### Casing:

- soft wood
- hardwood of European origin
- hard wood (oil finish)
- premium hard wood
- HPL

### Methods of installation:

- attached by bolts to foundation

### Ashtray:

- include

### Container:

- galvanized steel container

## DESCRIPTION

Altus 03.052.01 is a vandal resistant **modern litter bin**. Ideal for parks, playgrounds, shopping centres and other urban environments. **Steel** and **timber** have long been used as main materials for manufacturing **litter bins**. Thanks to it, presented **litter bin** is ideal for busy, modern locations such as town centres and other public spaces. **Stainless steel** is hardwearing, **corrosion resistant** and requires minimal maintenance. ZANO Street Furniture **modern litter bin** is also available in all RAL palette standard colours.

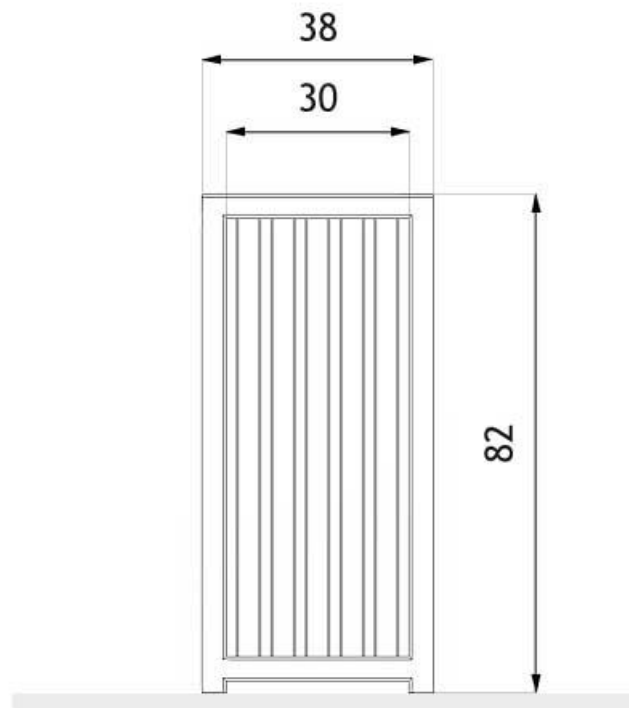

wymiary podane w [cm]

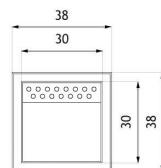

wymiary podane w [cm]

## GENERAL TECHNICAL DATA

### Dimensions:

- width: 38 cm
- height: 82 cm

### Weight:

- 38 kg

### Capacity:

- capacity: 55 l
- capacity of ashtray: 1 l

### Materials:

- stainless steel profiles
- galvanised sheet metal insert
- wooden planks

ZANO



*M. Welmiński*

Product: Altus Litter Bin  
Catalog number: **03.052.01**  
Designer:  
Mateusz Welmiński

In accordance with the Polish Law on Copyright and Related Rights of 04.02.1994 (Official Journal of Laws No. 24, item 83, corrected: Journal of Laws No. 43, item 170) and in accordance with the EU copyright legislation including all EU directives and regulations on copyright, Zano Mirosław Zarotynski Company, reserves the copyright of drawings, descriptions, 3D models, renderings, graphics, content contained in offers, attachments to offers and all other documents. Its content is the intellectual property of ZANO Mirosław Zarotynski company. The use of author's ideas, solutions, copying, distribution of photos, graphics or fragments of graphics, descriptive texts, for profit, without the permission of the author - ZANO Mirosław Zarotynski company - is prohibited and constitutes a copyright infringement and is punishable.

**NOTE:** The drawings do not reflect the actual dimensions of the foundation. They are only exemplary assembly schemes taking into account the type of anchoring and the substrate material to which the furniture is to be fixed.

The size of the foundation depends on the local foundation conditions.



### INSTALLATION INTO PAVING WITH FOUNDATION

#### Description of the assembly

1. ZANO product
2. Quick-action fastener or chemical anchor
3. Stone paving / concrete paving / stone slabs / concrete slabs
4. Sand ballast (approx. 2 - 4 cm)
5. Stone aggregate substructure
6. Concrete foundation, class C16/20 (top surface concrete 10 cm below paving surface)
7. Ground

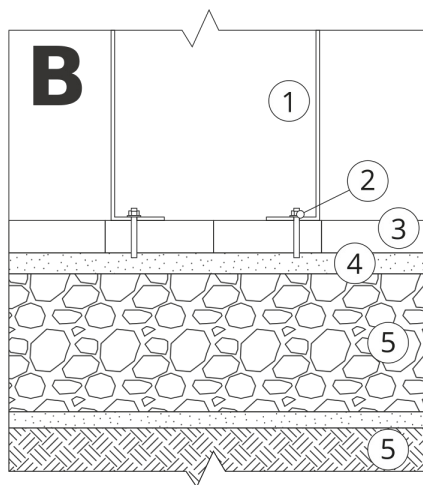

### INSTALLATION TO PAVING

#### Description of the assembly

1. ZANO product
2. Quick-action fastener or chemical anchor
3. Stone paving / concrete paving / stone slabs / concrete slabs
4. Sand ballast (approx. 2 - 4 cm)
5. Stone aggregate substructure
6. Ground

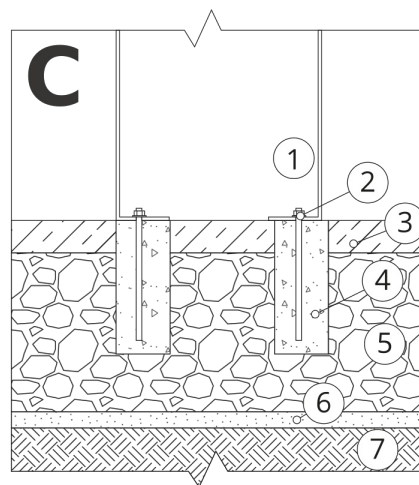

### CONCRETE / ASPHALT MOUNTING

#### Description of the assembly

1. ZANO product
2. Quick-action fastener or chemical anchor
3. Fixed hardened surface e.g. concrete or asphalt
4. Concrete foundation, class C16/20 (top surface concrete 10 cm below paving surface)
5. Stone aggregate substructure
6. Sand ballast (approx. 2 - 4 cm)
7. Ground

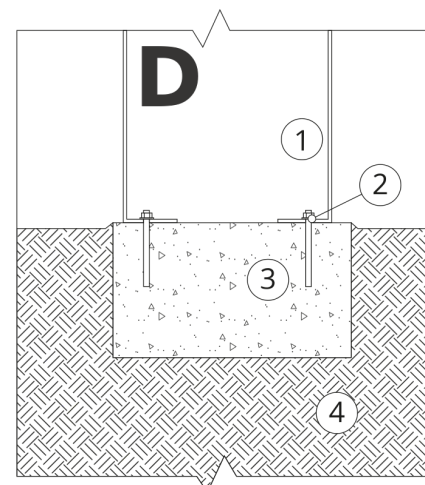

### MOUNTING TO CONCRETE FOUNDATION

#### Description of the assembly

1. ZANO product
2. Quick-action fastener or chemical anchor
3. Concrete foundation, class C16/20 (top surface concrete 10 cm below paving surface)
4. Ground