



OPTIONS

Construction:

- carbon steel (s235Jr)
- stainless steel (Aisi 304)

Seat and backrest:

- soft wood
- hardwood of European origin
- hard wood (oil finish)
- premium hard wood

Methods of installation:

- attached by bolts to foundation

Sound module:

- none
- bluetooth speaker
- speaker with built-in memory

Battery pack:

- gel batteries 36 Ah
- lithium batteries 40 Ah

Wi-Fi hotspot:

- none
- 2.4 GHz; 3G, 4G (no SIM card included)

Logo:

- none
- milled in wood

DESCRIPTION



The Flash solar bench is a modern solution for urban spaces, equipped with a **photovoltaic panel** that provides full autonomous operation. As a result, it does not need to be connected to the electricity grid, allowing it to be freely placed anywhere without worrying about the reliability of its function.

The Flash bench offers three USB A 3.0 charging ports as well as a wireless...

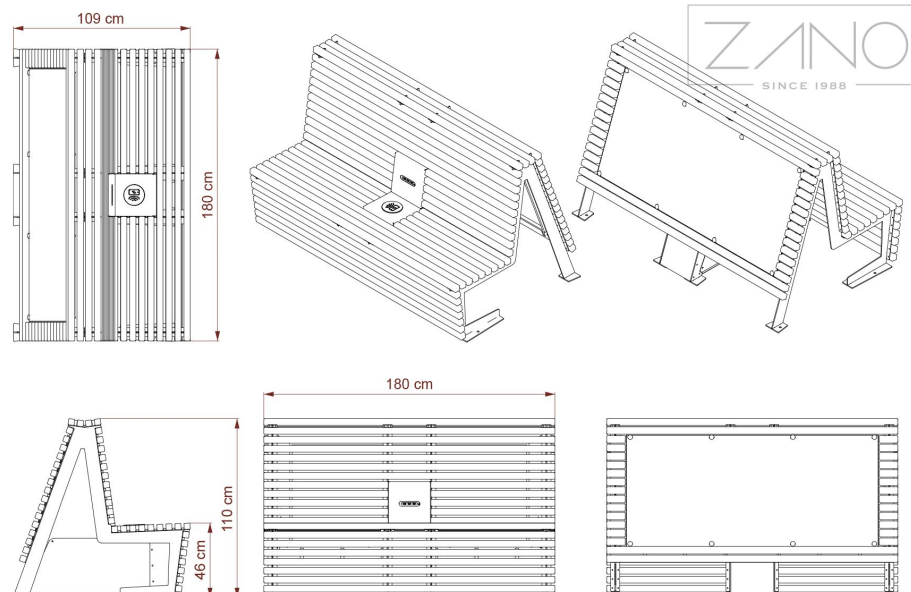

GENERAL TECHNICAL DATA

Dimensions:

- width: 180 cm
- height: 110 cm
- depth: 109 cm

Weight:

- soft wood: 200 kg
- hardwood of European origin: 228 kg

Basic equipment:

- three USB A quick charge ports
- inductive charger

Electrical specifications:

- max. output of the photovoltaic panel: 160 W
- battery capacity: 55 Ah
- working temperature: -20°C - 60°C

Materials:

- European coniferous or exotic wood
- construction - stainless steel or carbon steel, galvanised and powder coated

ZANO



Iwona Żaczek

Product: Flash solar bench
 Catalog number: **02.025.3**
 Designer: Iwona Żaczek

In accordance with the Polish Law on Copyright and Related Rights of 04.02.1994 (Official Journal of Laws No. 24, item 83, corrected: Journal of Laws No. 43, item 170) and in accordance with the EU copyright legislation including all EU directives and regulations on copyright, Zano Mirosław Zarotynski Company, reserves the copyright of drawings, descriptions, 3D models, renderings, graphics, content contained in offers, attachments to offers and all other documents. Its content is the intellectual property of ZANO Mirosław Zarotynski company. The use of author's ideas, solutions, copying, distribution of photos, graphics or fragments of graphics, descriptive texts, for profit, without the permission of the author - ZANO Mirosław Zarotynski company - is prohibited and constitutes a copyright infringement and is punishable.

NOTE: The drawings do not reflect the actual dimensions of the foundation. They are only exemplary assembly schemes taking into account the type of anchoring and the substrate material to which the furniture is to be fixed.

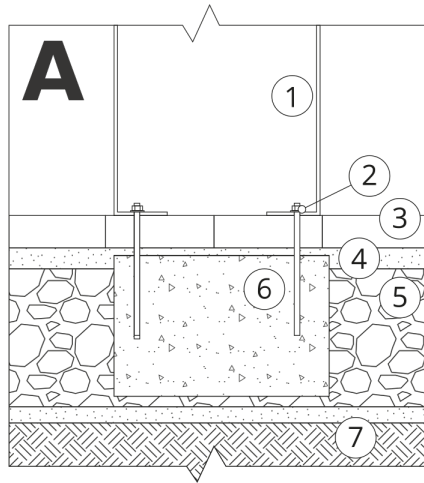
The size of the foundation depends on the local foundation conditions.



INSTALLATION INTO PAVING WITH FOUNDATION

Description of the assembly

1. ZANO product
2. Quick-action fastener or chemical anchor
3. Stone paving / concrete paving / stone slabs / concrete slabs
4. Sand ballast (approx. 2 - 4 cm)
5. Stone aggregate substructure
6. Concrete foundation, class C16/20 (top surface concrete 10 cm below paving surface)
7. Ground

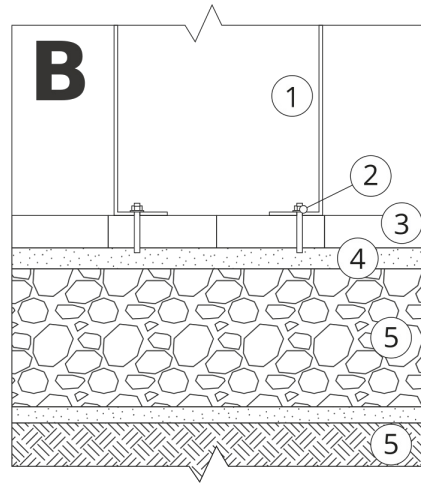

INSTALLATION TO PAVING

Description of the assembly

1. ZANO product
2. Quick-action fastener or chemical anchor
3. Stone paving / concrete paving / stone slabs / concrete slabs
4. Sand ballast (approx. 2 - 4 cm)
5. Stone aggregate substructure
6. Ground

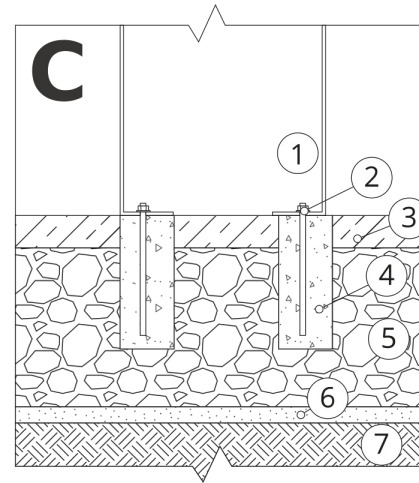

CONCRETE / ASPHALT MOUNTING

Description of the assembly

1. ZANO product
2. Quick-action fastener or chemical anchor
3. Fixed hardened surface e.g. concrete or asphalt
4. Concrete foundation, class C16/20 (top surface concrete 10 cm below paving surface)
5. Stone aggregate substructure
6. Sand ballast (approx. 2 - 4 cm)
7. Ground

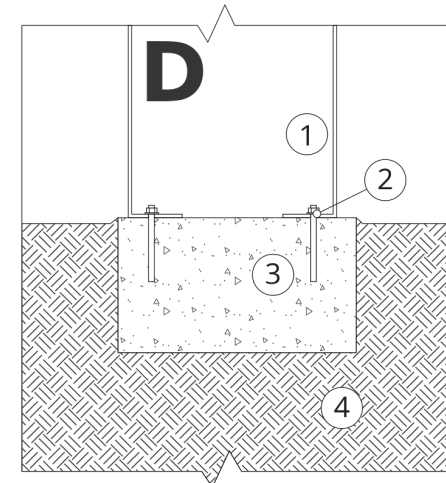

MOUNTING TO CONCRETE FOUNDATION

Description of the assembly

1. ZANO product
2. Quick-action fastener or chemical anchor
3. Concrete foundation, class C16/20 (top surface concrete 10 cm below paving surface)
4. Ground