



### GENERAL TECHNICAL DATA

#### dimensions:

- height: 45 cm
- width: 183 cm
- depth: 49 cm

#### weight:

- using softwood: 63 kg
- using hardwood: 72 kg

#### materials:

- softwood or hardwood
- stainless or carbon steel

### DESCRIPTION:

Welded structure connected with wooden planks. Weld structure of 8 mm and 4mm thick steel sheets, carbon steel s235Jr galvanized and powder coated according to RAL palette or all stainless steel 1.4301 ground. Seat using seven wooden planks including five of 38 x 85mm section and 1800mm length and two of 38 x 38 section and 1800mm length. European coniferous wood impregnated and varnished twice or exotic wood impregnated and oiled twice.

All street furniture elements must be properly anchored according to the manufacturer's technical instructions. The manufacturer is not liable for damage caused by negligent use or failure to follow instructions.



*M. Wełmiński*

product:  
Simple bench  
02.424  
designer: M. Wełmiński

In accordance with the Polish Law on Copyright and Related Rights of 04.02.1994 (Official Journal of Laws No. 24, item 83, corrected: Journal of Laws No. 43, item 170) and in accordance with the EU copyright legislation including all EU directives and regulations on copyright, Zano Mirosław Zarotyński Company, reserves the copyright of drawings, descriptions, 3D models, renderings, graphics, content contained in offers, attachments to offers and all other documents. Its content is the intellectual property of ZANO Mirosław Zarotyński company. The use of author's ideas, solutions, copying, distribution of photos, graphics or fragments of graphics, descriptive texts, for profit, without the permission of the author - ZANO Mirosław Zarotyński company - is prohibited and constitutes a copyright infringement and is punishable.

TOP VIEW



MOUNTING HOLES SPACING

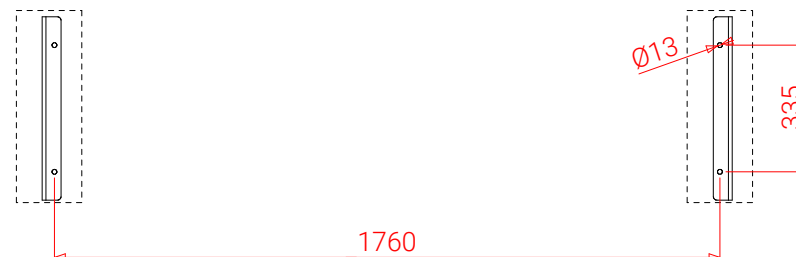

FRONT VIEW

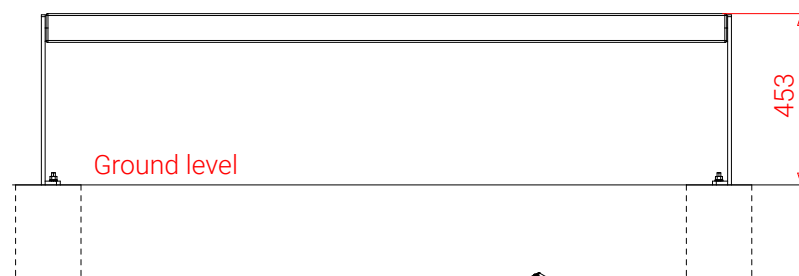

VERTICAL SECTION

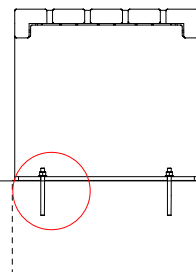

SIDE VIEW

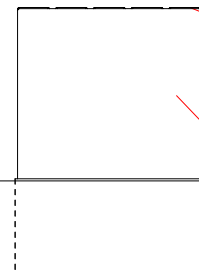

Wood types:

- softwood, lacquered
- Hardwood, oiled

Steel types:

- Construction steel (S235JR, DC01) galvanized and powder coated according to RAL palette
- Stainless steel (1.4301) brushed

ISOMETRIC VIEW

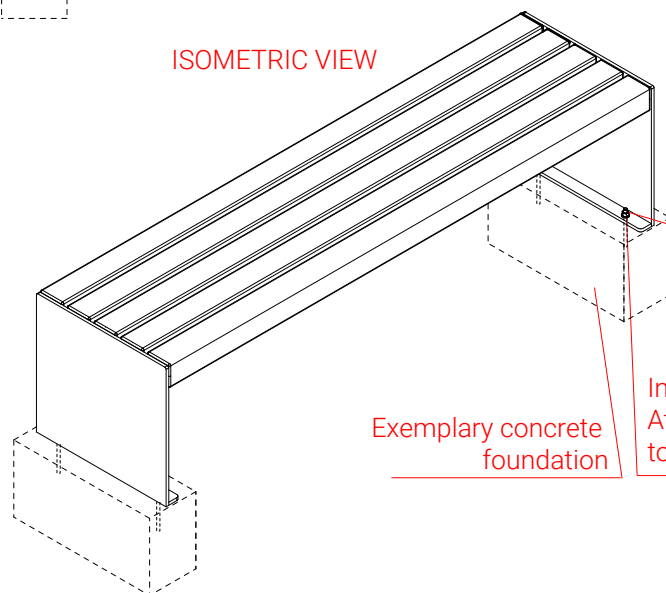

Exemplary concrete foundation

Installation:  
Attached by bolts to foundation

4 x Nut M10 DIN1587

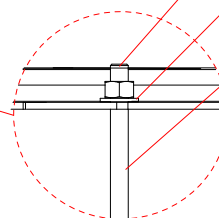
4 x Washer  
M10 DIN 1254 x Threaded rod  
M10x125 DIN 976-1

Dimensions given in [mm]

Simple bench  
02.424

In accordance with the Polish Law on Copyright and Related Rights of 04.02.1994 (Official Journal of Laws No. 24, item 83, corrected: Journal of Laws No. 43, item 170) and in accordance with the EU copyright legislation including all EU directives and regulations on copyright, Zano Mirosław Zarotyński Company, reserves the copyright of drawings, descriptions, 3D models, renderings, graphics, content contained in offers, attachments to offers and all other documents. Its content is the intellectual property of ZANO Mirosław Zarotyński company. The use of author's ideas, solutions, copying, distribution of photos, graphics or fragments of graphics, descriptive texts, for profit, without the permission of the author - ZANO Mirosław Zarotyński company - is prohibited and constitutes a copyright infringement and is punishable.

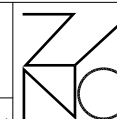
ZANO Street Furniture  
Lindego 7A, 30-148  
Cracow, Polandphone: +48 12 200 20 53  
email: office@zano.pl

Number: 250523-V1

Sheet: A4

Scale: 1:20

Mass: using softwood: 63 kg  
using hardwood: 72 kg