**GENERAL TECHNICAL DATA****dimensions:**

- height: 76 cm
- width: 120 cm
- depth: 120 cm

weight:

- 86 kg

materials:

- stainless or carbon steel
- hardwood or softwood

DESCRIPTION:

Bended and bolted structure made of 4 mm thick steel sheets, in carbon steel s235Jr galvanised and powder-coated according to RAL palette or entirely in stainless steel 1.4301 ground. Table top using 22 1186 x 25 mm boards, 2 1200 x 60 mm boards and 2 1096 x 57 mm boards. European coniferous wood impregnated and varnished twice, and exotic wood impregnated and oiled twice. The table has been adapted for disabled people in wheelchairs.

All landscaping elements must be properly anchored according to the manufacturer's technical instructions. The manufacturer is not liable for damage caused by negligent use or failure to follow the instructions.



Iwona Żaczek

product:
Table Stilo 13.048.1
designer: Iwona Żaczek

In accordance with the Polish Law on Copyright and Related Rights of 04.02.1994 (Official Journal of Laws No. 24, item 83, corrected: Journal of Laws No. 43, item 170) and in accordance with the EU copyright legislation including all EU directives and regulations on copyright, Zano Mirosław Zarotyński Company, reserves the copyright of drawings, descriptions, 3D models, renderings, graphics, content contained in offers, attachments to offers and all other documents. Its content is the intellectual property of ZANO Mirosław Zarotyński company. The use of author's ideas, solutions, copying, distribution of photos, graphics or fragments of graphics, descriptive texts, for profit, without the permission of the author - ZANO Mirosław Zarotyński company - is prohibited and constitutes a copyright infringement and is punishable.

TOP VIEW

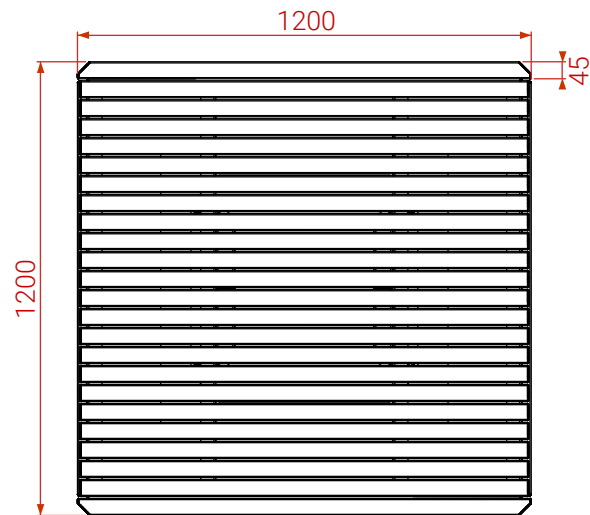
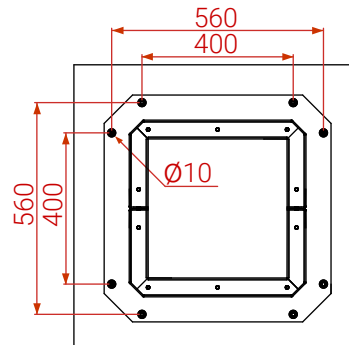
MOUNTING HOLES SPACING
(TOP VIEW)

ISOMETRIC VIEW

Wood types:
 - Softwood, lacquered
 - Hardwood, oiled

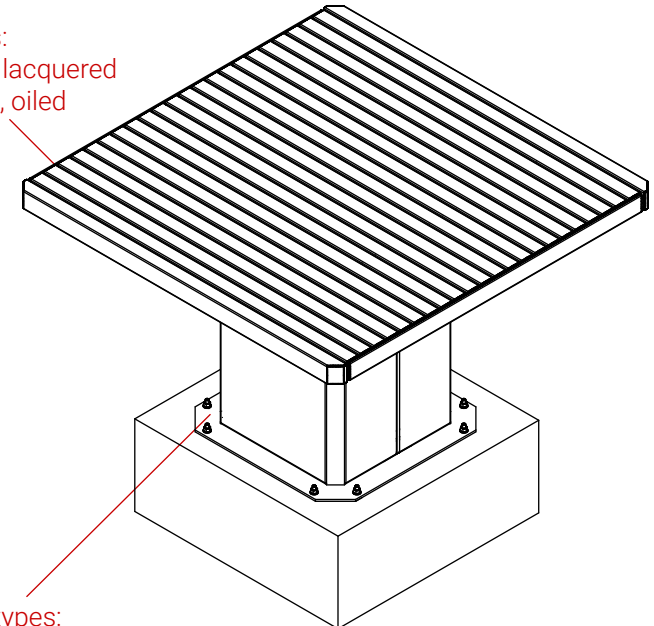

Steel types:
 - Construction steel (S235JR, DC01)
 galvanized and powder coated
 according to RAL palette
 - Stainless steel (1.4301) brushed

FRONT VIEW

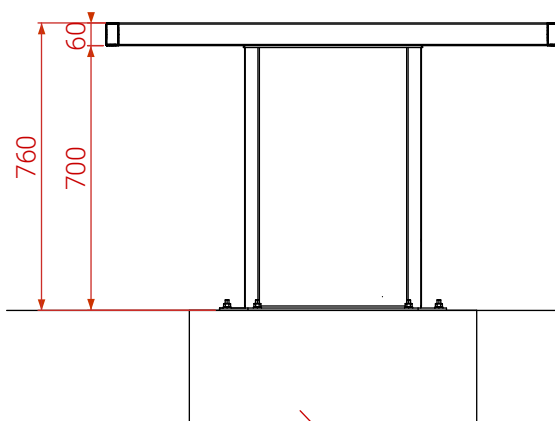

SIDE VIEW

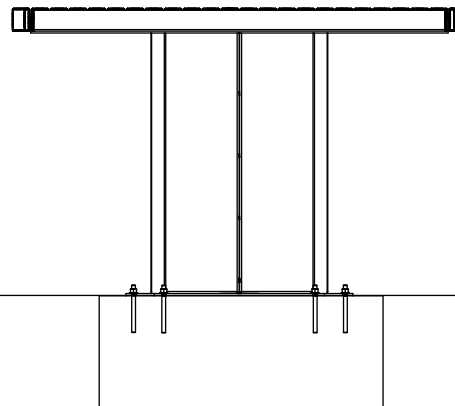

Exemplary
concrete foundation

Ground level

Dimensions given in [mm]

Table Stilo 13.048.1

In accordance with the Polish Law on Copyright and Related Rights of 04.02.1994 (Official Journal of Laws No. 24, item 83, corrected: Journal of Laws No. 43, item 170) and in accordance with the EU copyright legislation including all EU directives and regulations on copyright, Zano Miroslaw Zarotyski Company, reserves the copyright of drawings, descriptions, 3D models, renderings, graphics, content contained in offers, attachments to offers and all other documents. Its content is the intellectual property of ZANO Miroslaw Zarotyski company. The use of author's ideas, solutions, copying, distribution of photos, graphics or fragments of graphics, descriptive texts, for profit, without the permission of the author - ZANO Miroslaw Zarotyski company - is prohibited and constitutes a copyright infringement and is punishable.



ZANO Street Furniture
 Lindego 7A, 30-148
 Cracow, Poland
 phone: +48 12 200 20 53
 email: office@zano.pl

Number: 050822-V1

Sheet: A4

Scale: 1:20

Weight: 86 kg