

GENERAL TECHNICAL DATA

dimensions:

- height: 42 cm
- width: 90 cm
- depth: 90 cm

- weight:**
- using softwood: 78 kg
 - using hardwood: 86 kg

- materials:**
- stainless or carbon steel
 - softwood or hardwood

DESCRIPTION

Welded construction connected to wooden planks by joints. Welded construction of steel sheets 4 and 6 mm thick, carbon steel s235Jr galvanised and powder-coated according to RAL palette or entirely of ground stainless steel 1.4301.

Seat using 13 wooden boards with 80 x 38 mm rectangular section, 342-880 mm long. Softwood impregnated and varnished twice or hardwood impregnated and oiled twice.

All street furniture elements must be properly anchored according to the manufacturer's technical instructions. The manufacturer shall not be liable for damage caused by negligent use or failure to follow the instructions.



Filip Babiarz

product:
bench ORBIT 02.450.1
version: 2
designer: Filip Babiarz

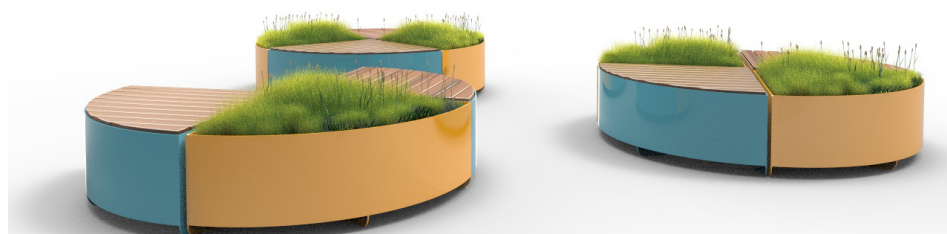

In accordance with the Polish Law on Copyright and Related Rights of 04.02.1994 (Official Journal of Laws No. 24, item 83, corrected: Journal of Laws No. 43, item 170) and in accordance with the EU copyright legislation including all EU directives and regulations on copyright, Zano Mirosław Zarotyński Company, reserves the copyright of drawings, descriptions, 3D models, renderings, graphics, content contained in offers, attachments to offers and all other documents. Its content is the intellectual property of ZANO Mirosław Zarotyński company. The use of author's ideas, solutions, copying, distribution of photos, graphics or fragments of graphics, descriptive texts, for profit, without the permission of the author - ZANO Mirosław Zarotyński company - is prohibited and constitutes a copyright infringement and is punishable.

FRONT VIEW

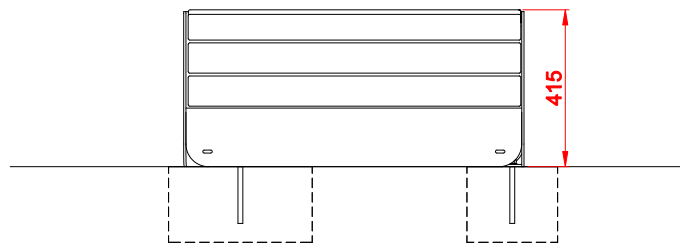

SIDE VIEW

Steel types:
 - Construction steel (S235JR, DC01) galvanized and powder coated according to RAL palette
 - Stainless steel (1.4301) brushed

Installation:
 - Attached by bolts to foundation

Exemplary concrete foundation

Ground level

TOP VIEW

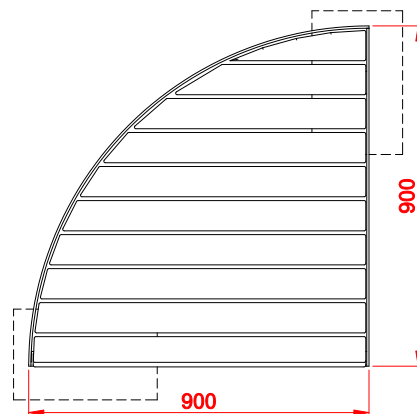

Wood types:
 - Soft wood, lacquered
 - Hard wood, oiled

ISOMETRIC VIEW

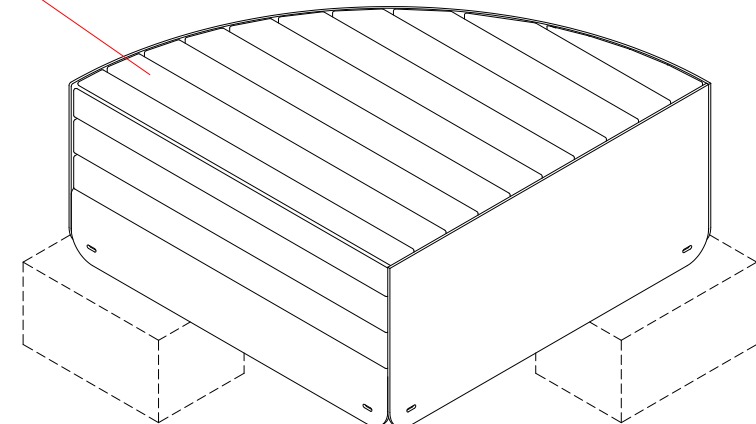

MOUNTING HOLES SPACING

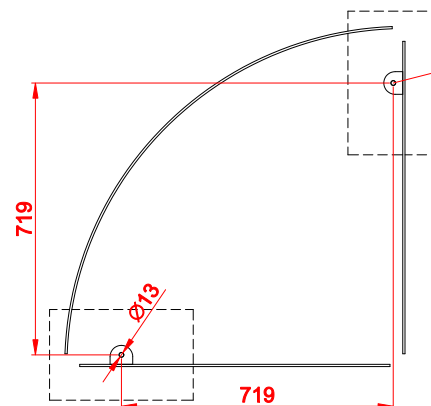

2x Nut M10 DIN1587

2x Washer M10 DIN125

2x Threaded rod
 M10x150 DIN976-1

Dimensions given in [mm]

Orbit Bench 02.450.1

In accordance with the Polish Law on Copyright and Related Rights of 04.02.1994 (Official Journal of Laws No. 24, Item 83, corrected: Journal of Laws No. 43, Item 170) and in accordance with the EU copyright legislation including all EU directives and regulations on copyright, ZANO Mirosław Zarotyński Company, reserves the copyright of drawings, descriptions, 3D models, renderings, graphics, content contained in offers, attachments to offers and all other documents. Its content is the intellectual property of ZANO Mirosław Zarotyński company. The use of author's ideas, solutions, copying, distribution of photos, graphics or fragments of graphics, descriptive texts, for profit, without the permission of the author - ZANO Mirosław Zarotyński company - is prohibited and constitutes a copyright infringement and is punishable.

ul. Lindego 7a,
 30-148 Cracow
 Poland
 phone: +48 12 200 20 53
 email: office@zano.pl

Number: 190719-v2
 Sheet: A4
 Scale: 1:20
 Mass: with soft wood 78 kg
 with hard wood 86 kg